

AGENDA

DES MOINES CITY COUNCIL TRANSPORTATION COMMITTEE

City Council Chambers
21630 11th Avenue S, Des Moines, Washington
Thursday, March 14, 2024 - 4:00 PM

Transportation Committee: Councilmember Gene Achziger, Councilmember Matt Mahoney, and Deputy Mayor Harry Steinmetz

AGENDA

- Item 1. SELECTION OF CHAIR AND VICE-CHAIR
- Item 2. APPROVAL OF MINUTES FROM THE FEBRUARY 08, 2024 MEETING
[02.08.24 Transportation Committee Minutes Draft Header](#)
- Item 3. CIP PROJECT UPDATES
 - *Staff will provide an update on Capital Improvement Plan Projects*
[Trans Committee CIP Update March 2024 TO](#)
- Item 4. WSDOT SR 509 INTERAGENCY AGREEMENT GCB3807
 - *Staff will present an update on the WSDOT SR 509 Interagency Agreement*
[3-14-24 TC Draft WSDOT SR 509](#)

ADJOURNMENT

Draft Des Moines City Council Transportation Committee Minutes – 02.08.2024

Meeting called to order: 4:00 PM on February 8, 2024 in the Council Chamber

Council Members

Gene Achziger
Matt Mahoney
Harry Steinmetz (absent)

City Staff

Tim George – Interim City Manager
Tyler Beekley – Acting Public Works Director
Denise Lathrop – Community Development Director
Khai Le – Acting City Engineer
Matt Hutchins – Acting City Attorney
Taria Keane – City Clerk
Sara Lee – Deputy City Clerk
Jodi Grager – Admin Assistant

Guests: Council Member Yoshiko Grace Matsui, Chuck Coleman

AGENDA:

1. Selection of Chair and Vice-Chair (delayed until next meeting)
2. Approval of 09.14.23 meeting minutes
3. 2024 Draft Work Plan

MEETING:

1. Unanimous approval of the 09.14.23 minutes.
2. Acting City Engineer Khai Le stated the Engineering Services Department has a busy year ahead. It is the intent to keep projects moving forward while facing the challenges of a limited staff. He reviewed the 2024 Draft Work Plan (Attachment #2). The committee members requested additional Sound Transit Updates potentially in April and October. Director Lathrop added that Community Development staff will coordinate with Engineering staff to present the Comprehensive Plan Update regarding Transportation details in April. The Comprehensive Plan focuses on goals, policies and strategies and must be reviewed and updated by December 31, 2024. The committee members are interested in Metro's Last Mile connectivity plan related to the Sound Transit Light Rail project and also requested an agenda item for Red Light Cameras later in the year. An additional item not listed on the agenda was discussed. The 24th Avenue Road Improvements Project will likely be suspended sometime in February. This will allow PSE to relocate without interference from an active construction zone. The City plans to hold PSE accountable for the cost of the construction delay which may add up to three months to the overall timeline.

Adjourned at 4:14 p.m. Minutes respectfully submitted by Jodi Grager, Admin Assistant

Transportation Committee
March 2024
Capital Project Update

Current Construction	Phase	Status/Comment
College Way (Sound Transit)	CN	Under construction, anticipated completion this fall
2023 ADA Compliance Program	CN	Construction Complete; Project Close-Out
2023 Citywide Arterial Traffic Calming	CN	Construction Complete; Project Close-Out
24th Ave S Sidewalks (Midway Elementary) - TIB	CN	Under suspension of work due to utility conflicts
Planning, Engineering, ROW Acquisition		Status/Comment
Marina Steps	PE	Design ongoing with consultant KPFF, coordination with utilities
S 200th St & S 199th St Improvements (Segment 1) North Hill Elementary Walkway	PE	Successful WSDOT Safe Routes to School Grant; Design/ROW acquisition ongoing with Parametrix
Barnes Creek Trail - South Segment 240th (16th to 20th)	PE	State Appropriation Awarded; Design ongoing with KPG-PSOMAS
South 223rd Street Complete Streets Improvements	PE	Planning work completed with consultant KPG-PSOMAS
2024 ADA Compliance Program	PE	Engineering Evaluation
2024 Citywide Arterial Traffic Calming	PE	Engineering Evaluation
2024 Guardrail Program	PE	Engineering Evaluation
South 240th Street Improvements - Segment 2	PE	
S 224th Street Improvements (PHS -30th Ave S)	PE	
16th Ave S - Segment 5A	PE	
MVD/240th Capacity Improvements	PE	
Planned Construction		Status/Comment
Redondo Fishing Pier, Bulkhead, Restroom Replacement	CN	Federal, State & Local permits complete; Construction anticipated summer 2024
2024 Arterial Street Pavement Preservation	CN	2024 Overlay Program Recommended for Construction Contract Award March 2024
Large Project Support		Status/Comment
Sound Transit Light Rail	PE/CN	College Way and Pac Ridge improvements for construction in 2024
WSDOT SR509	PE/CN	Continued Support
WSDOT S 216th Bridge	PE/CN	Construction ongoing; Reroute WB to new bridge/EB closure through summer 2024
WSDOT SR99 Pavement Preservation	PE	Continued Support; Advertisement for bids in May 2024 pending legislative action for funding
Projects Targeted for Grant Funding:		Status/Comment
S 200th St & S 199th St Improvements (Segment 1) North Hill Elementary Walkway		Successful \$3M Safe Routes to School Grant - Awards made July 2023
Marina Steps		Successful \$1M WA State legislative appropriation - Awards made July 2023
Redondo Fishing Pier		Successful \$1M WA State legislative appropriation - Awards made July 2023
Barnes Creek Trail - South Segment 240th (16th to 20th)		Successful \$3.5M WA State Moving WA Forward - Awards made July 2023
Redondo Fishing Pier (Restroom)		Successful \$650K WA State RCO - Award made July 2023
		Working on
		Planning on, some risk
		Resource/Schedule Risk



WSDOT SR 509 INTERAGENCY AGREEMENT GCB3807 MARCH 2024

BACKGROUND

- State Legislature funded the SR 509 Completion Project in 2015
- Overall project is three stages, Stage 1A is complete, Stage 1B is currently under construction
- Stage 2 of the SR 509 Completion Project, called the SR 509/24th Avenue South to South 188th Street – New Expressway Project, is the project's final stage
- Stage 2 includes constructing mitigation or buffer impacts and wetland conversion on the historic WSDOT owned right-of-way ("ROW") at the Barnes Creek Site (see attached exhibit)
- GCB3807 was developed between the agencies to define the terms and commitments of WSDOT within the City

HIGHLIGHTS OF AGREEMENT

- Termination of S 194th Street at 11th Place S
- Mitigation for buffer impacts to be installed within historic SR 509 ROW
 - remove all invasive plants
 - preserve and enhance native plant communities and forest character
 - removal of hazard trees
 - prevent access to sensitive restoration areas
- Existing trail will be improved as a stabilized path to be utilized for construction and maintenance access
- Potential for betterments of the trail utilizing Design Build contractor if City funding allows
- WSDOT to maintain until property conveyance to the City in the future under a separate real estate transaction
- Historic WSDOT ROW may be considered for future conveyance to City at no cost to the City

NEXT STEPS

- March 28th City Council Meeting

BARNES CREEK WETLAND MITIGATION

CONCEPTUAL RESTORATION LEGEND

- NO WORK- STEEP SLOPES
- TYPE 1 RESTORATION*
- TYPE 2 RESTORATION*
- TYPE 3 RESTORATION*
- TYPE 4 RESTORATION*
- POTENTIAL HAZARD TREES
- AREA OF NEIGHBOR INCURSION
- EXISTING WETLAND
- BARNES CREEK TRAIL BY CITY OF DES MOINES
- POTENTIAL SITE ACCESS (TBD BY DESIGN-BUILDER)
- TOP OF STEEP SLOPE- BIOENGINEERING NEEDED
- EXISTING SEWER

* SEE SHEET 3 FOR DESCRIPTION OF RESTORATION TYPES.

T.22N. R.4E. W.M.

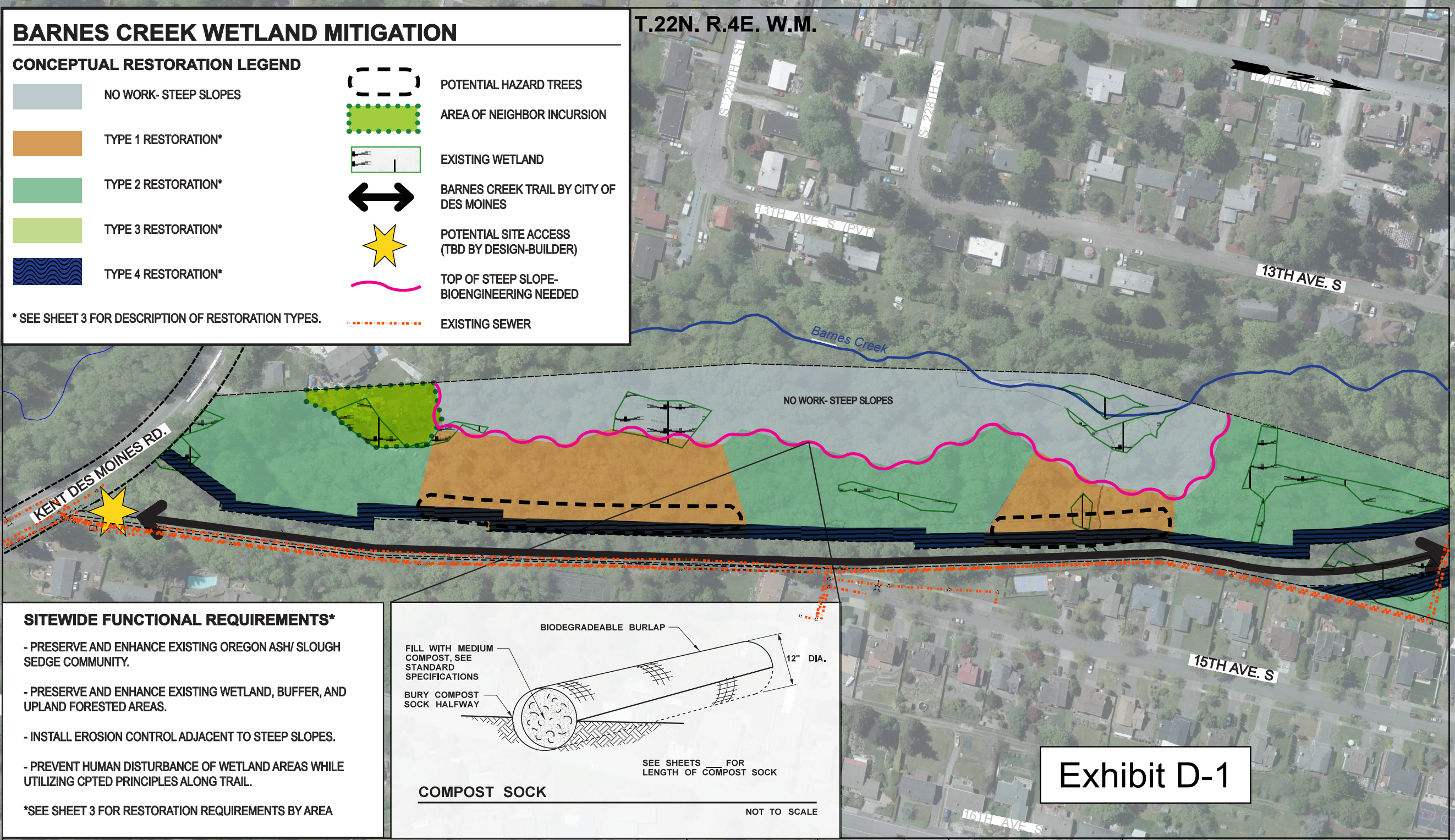

SITEWIDE FUNCTIONAL REQUIREMENTS*

- PRESERVE AND ENHANCE EXISTING OREGON ASH/ SLOUGH SEDGE COMMUNITY.
- PRESERVE AND ENHANCE EXISTING WETLAND, BUFFER, AND UPLAND FORESTED AREAS.
- INSTALL EROSION CONTROL ADJACENT TO STEEP SLOPES.
- PREVENT HUMAN DISTURBANCE OF WETLAND AREAS WHILE UTILIZING CPTED PRINCIPLES ALONG TRAIL.

*SEE SHEET 3 FOR RESTORATION REQUIREMENTS BY AREA

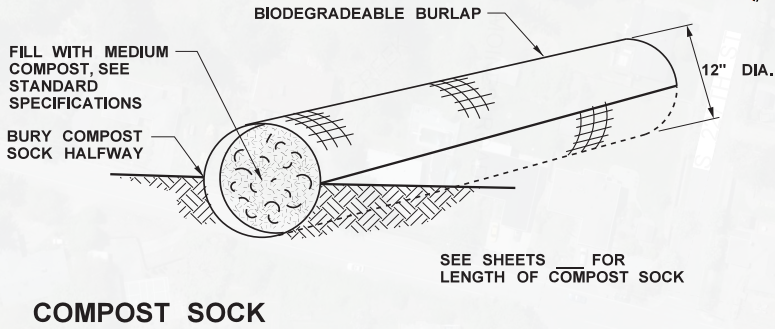





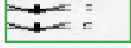







Exhibit D-1

BARNES CREEK WETLAND MITIGATION

CONCEPTUAL RESTORATION LEGEND

	NO WORK- STEEP SLOPES		POTENTIAL HAZARD TREES
	TYPE 1 RESTORATION*		AREA OF NEIGHBOR INCURSION
	TYPE 2 RESTORATION*		EXISTING WETLAND
	TYPE 3 RESTORATION*		BARNES CREEK TRAIL BY CITY OF DES MOINES
	TYPE 4 RESTORATION*		POTENTIAL SITE ACCESS (TBD BY DESIGN-BUILDER)
			TOP OF STEEP SLOPE- BIOENGINEERING NEEDED
			EXISTING SEWER

* SEE SHEET 3 FOR DESCRIPTION OF RESTORATION TYPES.

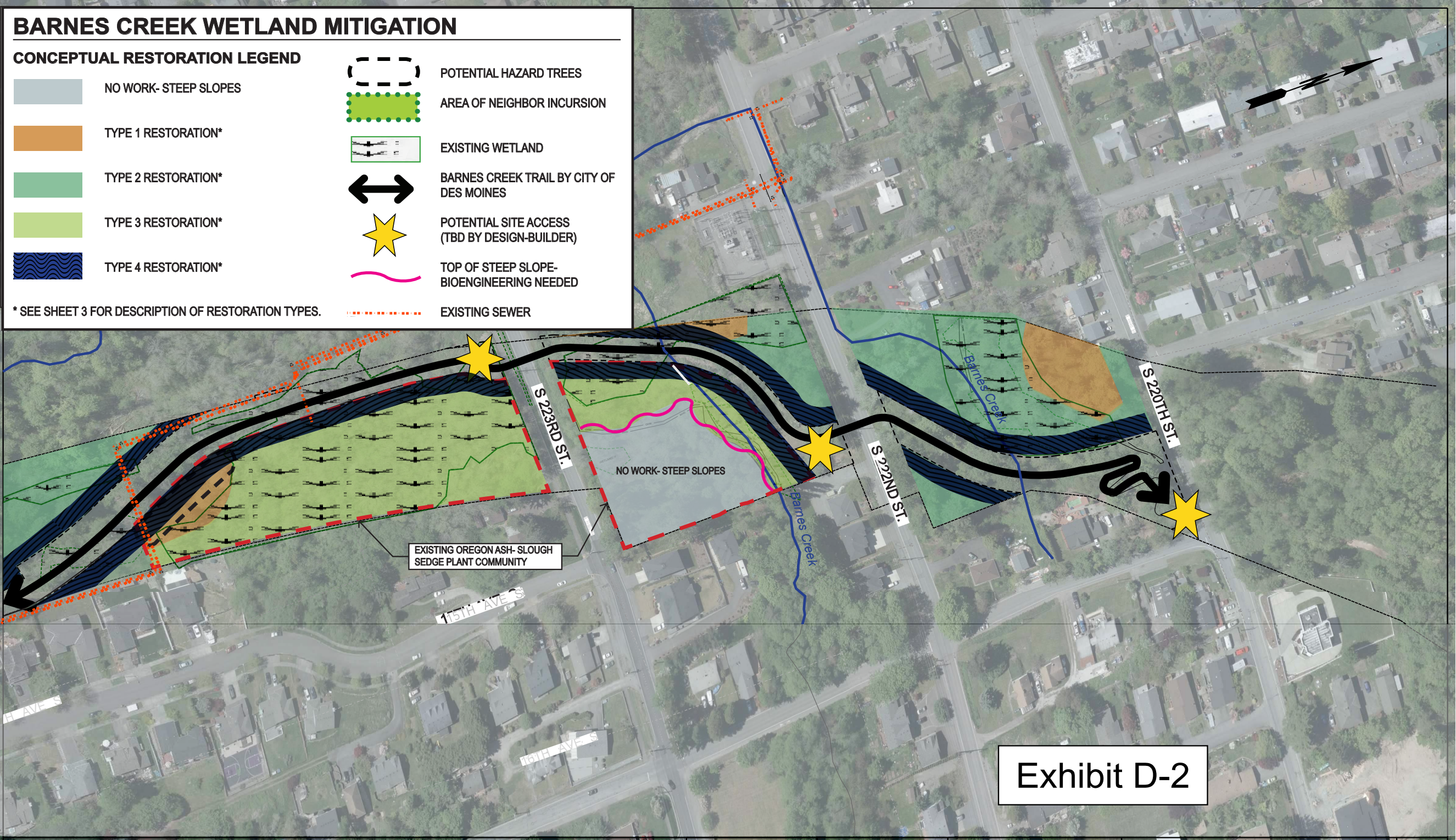

BARNES CREEK WETLAND MITIGATION

RESTORATION REQUIREMENTS BY AREA (SEE CONCEPTUAL RESTORATION PLANS)

TYPE 1 RESTORATION

FUNCTIONAL GOAL:
ERADICATE ALL INVASIVE PLANTS WHILE PRESERVING NATIVE SOIL AND FORESTED CHARACTER TO THE GREATEST EXTENT FEASIBLE.

RESTORATION REQUIREMENTS:

- ERADICATE ALL WASHINGTON CLASS A, B, AND C NOXIOUS WEEDS AND ANY PLANTS ON THE NOXIOUS WEED MONITOR LIST.
- INITIAL HERBICIDE APPLICATION AND MECHANICAL CLEARING AND GRUBBING MAY BE USED.
- ALL TREES SHALL BE EVALUATED BY A CERTIFIED ARBORIST AND REMOVED IF DEEMED HAZARDOUS TO PUBLIC TRAIL USERS, OR IF OVERTAKEN WITH IVY.
- MACHINERY USED ON-SITE SHALL BE NO MORE THAN 5 MAXIMUM PSI.
- ENSURE NO NEW GROWTH OF NOXIOUS WEEDS DURING WARRANTY PERIOD
- REPLANT ALL DISTURBED AREAS AT MAXIMUM 4’ SPACING, USING THE SPECIFIED PLANTING MIXES AS APPROPRIATE FOR SITE CONDITIONS.
- PLANTING COVERAGE SHALL INCLUDE A MINIMUM OF 25% LARGE NATIVE CONIFERS AND 20% SMALLER DECIDUOUS SPECIES.
- TO PRESERVE EXISTING SOIL AND MINIMIZE WEED PRESSURE, NO SOIL AMENDMENT SHALL BE UTILIZED.
- APPLY 3” WOOD CHIP MULCH TO ALL DISTURBED AREAS.
- INSTALL COMPOST SOCKS ON SLOPES 2:1 OR GREATER.

TYPE 2 RESTORATION

FUNCTIONAL GOAL:
REMOVE ALL INVASIVE PLANTS WHILE PRESERVING AND ENHANCING EXISTING NATIVE PLANT COMMUNITIES TO THE GREATEST EXTENT FEASIBLE. PRESERVE AND ENHANCE FORESTED CHARACTER.

RESTORATION REQUIREMENTS:

- REMOVE ALL WASHINGTON CLASS A, B, AND C NOXIOUS WEEDS AND ANY PLANTS ON THE NOXIOUS WEED MONITOR LIST.
- NO HERBICIDE SHALL BE USED. MECHANICAL AND HAND-CUTTING/ PULLING MAY BE USED TO REMOVE INVASIVE MATERIAL.
- ALL TREES SHALL BE EVALUATED BY A CERTIFIED ARBORIST AND REMOVED IF DEEMED HAZARDOUS TO PUBLIC TRAIL USERS, OR IF OVERTAKEN WITH IVY.
- MACHINERY USED ON-SITE SHALL BE NO MORE THAN 5 MAXIMUM PSI.
- ENSURE NO NEW GROWTH OF NOXIOUS WEEDS DURING WARRANTY PERIOD
- REPLANT ALL DISTURBED AREAS AT MAXIMUM 4’ SPACING, USING THE SPECIFIED PLANTING MIXES AS APPROPRIATE FOR SITE CONDITIONS.
- PLANTING COVERAGE SHALL INCLUDE A MINIMUM OF 20% LARGE NATIVE CONIFERS AND 10% SMALLER DECIDUOUS SPECIES.
- TO PRESERVE EXISTING SOIL AND MINIMIZE WEED PRESSURE, NO SOIL AMENDMENT SHALL BE UTILIZED.
- APPLY 3” WOOD CHIP MULCH TO ALL DISTURBED AREAS.
- INSTALL COMPOST SOCKS ON SLOPES 2:1 OR GREATER.

TYPE 3 RESTORATION

FUNCTIONAL GOAL:
PRESERVE AND ENHANCE EXISTING OREGON ASH-SLOUGH SEDGE WETLAND PLANT COMMUNITY WHILE MINIMIZING DISTURBANCE. PRESERVE AND ENHANCE OREGON ASH DECIDUOUS FORESTED CHARACTER.

RESTORATION REQUIREMENTS:

- REMOVE ALL WASHINGTON CLASS A, B, AND C NOXIOUS WEEDS AND ANY PLANTS ON THE NOXIOUS WEED MONITOR LIST.
- UTILIZE INFILL PLANTING IN AREAS WITH REED CANARYGRASS TO ESTABLISH SHADE, UTILIZING OREGON ASH ENHANCEMENT MIX.
- NO HERBICIDE SHALL BE USED. MECHANICAL AND HAND-CUTTING/ PULLING MAY BE USED TO REMOVE INVASIVE MATERIAL.
- ALL TREES SHALL BE EVALUATED BY A CERTIFIED ARBORIST AND REMOVED IF DEEMED HAZARDOUS TO PUBLIC TRAIL USERS, OR IF OVERTAKEN WITH IVY.
- NO HEAVY MACHINERY SHALL BE USED ON-SITE.
- ENSURE NO NEW GROWTH OF WEEDS DURING WARRANTY PERIOD
- REPLANT ANY DISTURBED AREAS AT MAXIMUM 4’ SPACING, USING THE SPECIFIED OREGON ASH- SLOUGH SEDGE ENHANCEMENT MIX. UTILIZE INFILL PLANTING TO ENHANCE CANOPY COVER.
- PLANTING COVERAGE SHALL INCLUDE A MINIMUM OF 10% TREES AND 40% EMERGENT UNDERSTORY.
- TO PRESERVE EXISTING SOIL AND MINIMIZE WEED PRESSURE, NO SOIL AMENDMENT SHALL BE UTILIZED.
- APPLY 3” WOOD CHIP MULCH TO ALL DISTURBED AREAS.
- INSTALL COMPOST SOCKS ON SLOPES 2:1 OR GREATER.

TYPE 4 RESTORATION

FUNCTIONAL GOAL:
PREVENT ACCESS TO SENSITIVE RESTORATION AREAS WHILE UTILIZING CPTED PRINCIPLES ALONG THE PUBLIC TRAIL.

RESTORATION REQUIREMENTS:

- REMOVE ALL WASHINGTON CLASS A, B, AND C NOXIOUS WEEDS AND ANY PLANTS ON THE NOXIOUS WEED MONITOR LIST.
- INITIAL HERBICIDE APPLICATION AND MECHANICAL CLEARING AND GRUBBING MAY BE USED.
- ALL TREES SHALL BE EVALUATED BY A CERTIFIED ARBORIST AND REMOVED IF DEEMED HAZARDOUS TO PUBLIC TRAIL USERS, OR IF OVERTAKEN WITH IVY.
- MACHINERY USED ON-SITE SHALL BE NO MORE THAN 5 MAXIMUM PSI.
- ENSURE NO NEW GROWTH OF WEEDS DURING WARRANTY PERIOD
- REPLANT ANY DISTURBED AREAS AT MAXIMUM 4’ SPACING, USING THE SPECIFIED TRAIL EDGE PLANTING MIX.
- TO ENHANCE SAFETY BY PRESERVING SIGHTLINES, TRAIL EDGE PLANTING SHALL BE 100% SHRUB OR UNDERSTORY AND HAVE NO PLANTING ABOVE 6’ HEIGHT WITHIN 15’ OF THE TRAIL.
- TRAIL EDGE PLANTING SHALL INCLUDE A MINIMUM OF 30% THORNY SPECIES TO DISCOURAGE RESTORATION SITE ACCESS BY TRAIL USERS.
- TO PRESERVE EXISTING SOIL AND MINIMIZE WEED PRESSURE, NO SOIL AMENDMENT SHALL BE UTILIZED.
- APPLY 3” WOOD CHIP MULCH TO ALL DISTURBED AREAS.
- INSTALL COMPOST SOCKS ON SLOPES 2:1 OR GREATER.

CONCEPTUAL PLANT MIXES

TRAIL EDGE PLANTING

- SALMONBERRY/ RUBUS SPECTABILIS
- NOOTKA ROSE/ ROSA NUTKANA
- SWAMP ROSE/ ROSA PISOCARPA
- SNOWBERRY/ SYMPHORICARPOS ALBUS
- LOW OREGON GRAPE/ MAHONIA NERVOSA
- TALL OREGON GRAPE/ MAHONIA AQUIFOLIUM
- THIMBLEBERRY / RUBUS PARVIFLORUS
- SWORD FERN/ POLYSTICHUM MUNITUM
- LADY FERN/ ATHYRIUM FELIX-FEMINA
- SALAL / GAULTHERIA SHALLON

WETLAND EMERGENT MIX

- SLOUGH SEDGE/ CAREX OBNUPTA
- SAWBEAK SEDGE / CAREX STIPATA
- WATER PARSLEY/ OENANTHE SARMENTOSA
- DAGGER- LEAF RUSH/ JUNCUS ENSIFOLIUS
- SMALL-FRUITED BULRUSH / SCIRPUS MICROCARPUS
- SKUNK CABBAGE/ LYSICHTON AMERICANUS

BUFFER PLANTING

- BIG LEAF MAPLE/ ACER MACROPHYLLUM
- WESTERN RED CEDAR/ THUJA PLICATA
- BEAKED HAZELNUT/ CORYLUS CORNUTA
- INDIAN PLUM/ OEMLERIA CERACIFORMIS
- NOOTKA ROSE/ ROSA NUTKANA
- RED-OSIER DOGWOOD/ CORNUS SERICEA
- EVERGREEN HUCKLEBERRY/ VACCINIUM OVATUM
- DOUGLAS SPIRAEA/ SPIRAEA DOUGLASII
- TWINBERRY/ LONICERA INVOLUCRATA
- SALAL/ GAULTHERIA SHALLON

UPLAND ENHANCEMENT PLANTING

- BIG LEAF MAPLE/ ACER MACROPHYLLUM
- DOUGLAS FIR/ PSEUDOTSUGA MENZIESII
- WESTERN RED CEDAR/ THUJA PLICATA
- GRAND FIR/ ABIES GRANDIS
- CASCARA/ RHAMNUS PURSHIANA
- WESTERN HEMLOCK/ TSUGA HETEROPHYLLA
- VINE MAPLE/ ACER CIRCINATUM
- SCOULER'S WILLOW/ SALIX SCOULERIANA
- EVERGREEN HUCKLEBERRY / VACCINIUM OVATUM
- TWINBERRY/ LONICERA INVOLUCRATA
- BEAKED HAZELNUT/ CORYLUS CORNUTA
- SALAL/ GAULTHERIA SHALLON
- ELDERBERRY/ SAMBUCUS RACEMOSA

OREGON ASH/ SLOUGH SEDGE ENHANCEMENT PLANTING

- OREGON ASH/ FRAXINUS LATIFOLIA
- RED ALDER/ ALNUS RUBRA (NO MORE THAN 1% OF MIX)
- CASCARA/ RHAMNUS PURSHIANA
- SCOULER'S WILLOW/ SALIX SCOULERIANA
- SALMONBERRY/ RUBUS SPECTABILIS
- RED ELDERBERRY/ SAMBUCUS RACEMOSA
- DOUGLAS SPIRAEA/ SPIRAEA DOUGLASII
- SLOUGH SEDGE/ CAREX OBNUPTA
- TALL MANNAGRASS/ GLYCERIA ELATA
- LADY FERN/ ATHYRIUM FELIX-FEMINA
- SWORD FERN/ POLYSTICHUM MUNITUM
- WATER PARSLEY/ OENANTHE SARMENTOSA