

Checked By R.T. Sept. 1939

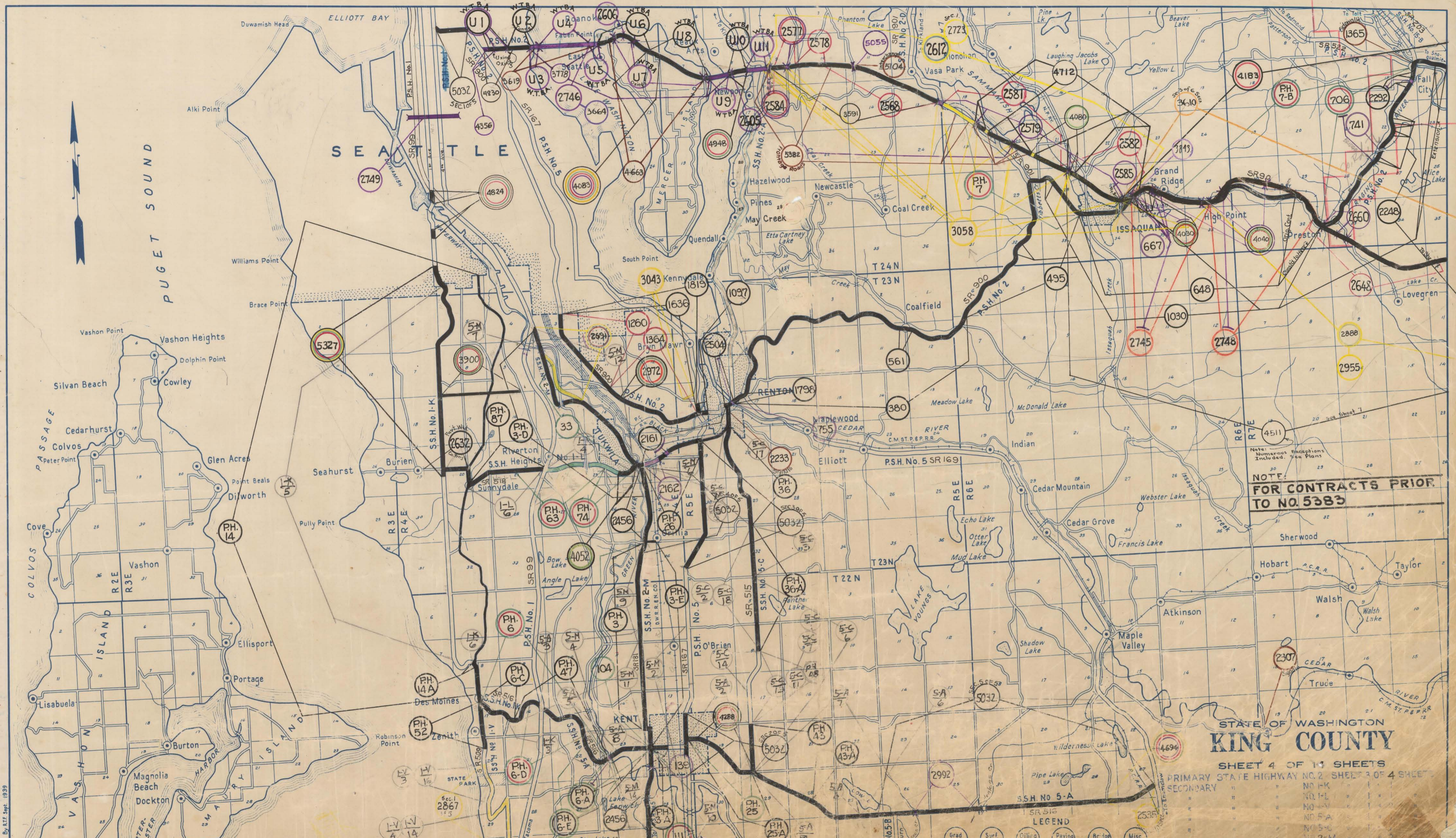

NOTE:  
FOR CONTRACTS PRIOR  
TO NO. 5383

STATE OF WASHINGTON  
**KING COUNTY**

SHEET 4 OF 10 SHEETS

PRIMARY STATE HIGHWAY NO. 2	SHEET 3 OF 4 SHEETS
SECONDARY	NO. 1-K
"	NO. 1-L
"	NO. 1-M
"	NO. 1-N
"	NO. 1-O
"	NO. 1-P
"	NO. 1-Q
"	NO. 1-R
"	NO. 1-S
"	NO. 1-T
"	NO. 1-U
"	NO. 1-V
"	NO. 1-W
"	NO. 1-X
"	NO. 1-Y
"	NO. 1-Z

LEGEND

Grad Red	Surf Green	Oiling Yellow	Paving black	Bridge Purple	Misc Brown
----------	------------	---------------	--------------	---------------	------------

Date	Revision	BY
1-18-54	Corporate Limits of Bellevue Shown	W.D.P.
1-16-57	Interstate Rt. 1 shown	J.F.R.
1-29-58	Deleted SSH 2-A, Added to PSH 1 & 2, Rev. SSH 1 & 1-L	G.C.H.
1-5-59	West Marginal Way Relocated	H.C.S.
9-27-62	PSH No. 2 Alignment Revised, Auburn to Echo Lake	H.C.S.
3-6-68	Added SR No's. SR 99T & Rev. Alignment SR 405 & SR 167	J.F.B.
5-18-70	Added SR No's.	J.E.L.
10-27-70	Revised Alignment SR 900 in Renton	J.E.L.

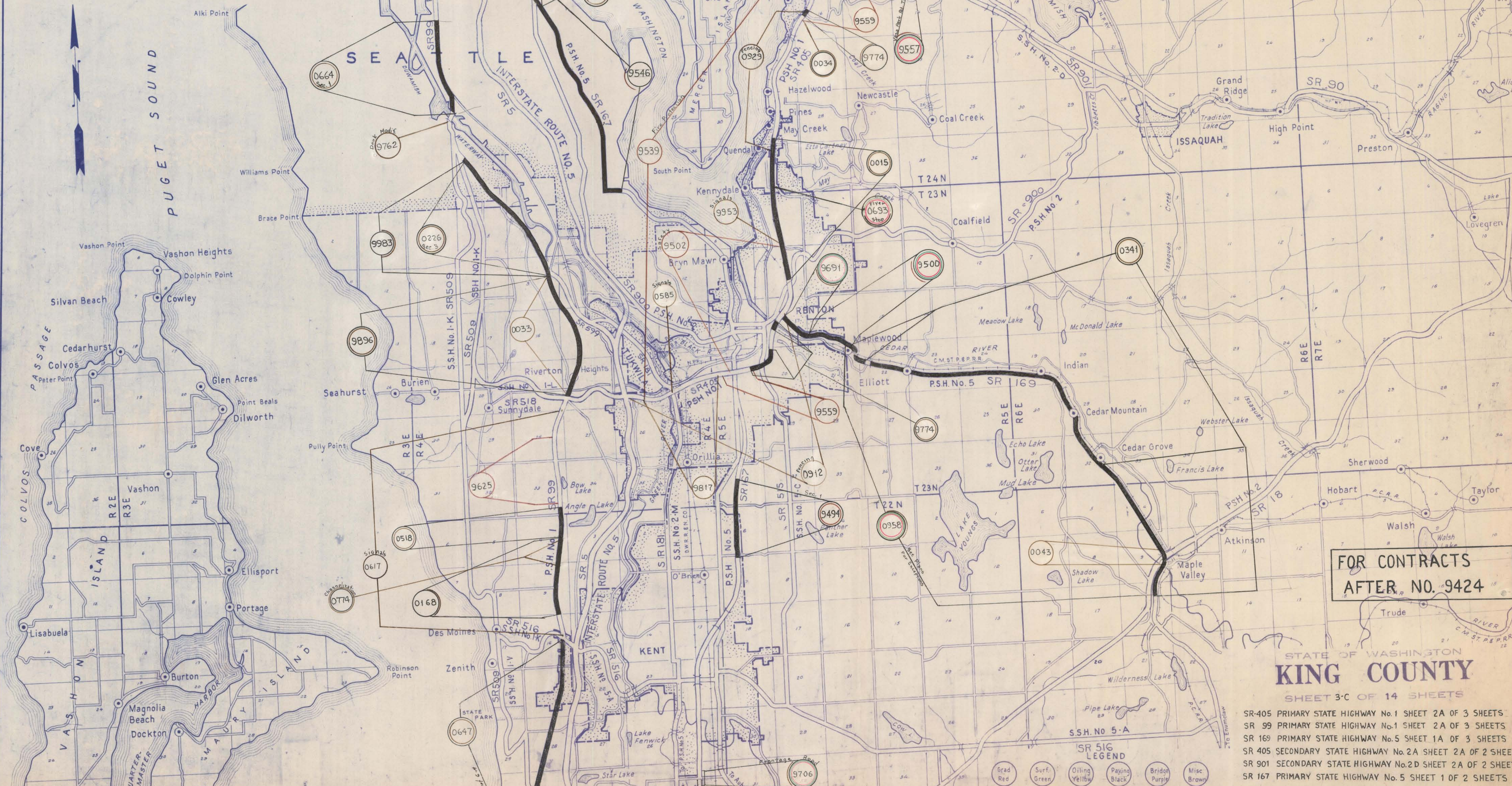

**FOR CONTRACTS  
AFTER NO. 9424**

STATE OF WASHINGTON  
**KING COUNTY**

SHEET 3-C OF 14 SHEETS

- SR 405 PRIMARY STATE HIGHWAY No. 1 SHEET 2A OF 3 SHEETS
- SR 99 PRIMARY STATE HIGHWAY No. 1 SHEET 2A OF 3 SHEETS
- SR 169 PRIMARY STATE HIGHWAY No. 5 SHEET 1A OF 3 SHEETS
- SR 405 SECONDARY STATE HIGHWAY No. 2A SHEET 2A OF 2 SHEETS
- SR 901 SECONDARY STATE HIGHWAY No. 2D SHEET 2A OF 2 SHEETS
- SR 167 PRIMARY STATE HIGHWAY No. 5 SHEET 1 OF 2 SHEETS

SR 516  
LEGEND

- Grad Red
- Surf. Green
- Oiling Yellow
- Paying Black
- Bridge Purple
- Misc. Brown

Checked By: T.F. Sept. 1939

# KING COUNTY IMPROVEMENTS

\* Part in other counties.

Cont. No.	Fed. Aid or Public Works No.	Per Hwy No.	Sheet No.	Section	Length	Type of Construction	Roadway Thickness	WIDTH		Total Cost Incl. Engr.	FUNDS			Contractor	Date of Comp.	Remarks
								Roadbed	Surface		State	Federal	City or County			
County "a"			3		1.51	Brick Pavement									1915	
County "b"			58,8		1.28	Grading									1912	
			1	Kirkland-Redmond	1.70	Bituminous Macadam									1911	
			1-A	"	2.50	Warrenite							H.S. Jordan		1913	
			1-B	East End P.H. 1-A Easterly & Southerly	1.64	Brick							L.R. Ellis		11-6-14	
			1-C	Redmond-Snoqualmie Rd.	6.83	Grading & Gravel Surfacing							S. Normile		10-20-15	
			2	Gehr-Erickson Rd.	2.50	Bituminous Macadam									1911	
			2-A	"	3.25	Grading & Gravel Surfacing							Wm. Martell		2-6-13	
			2-B	Extension State Aid Rd. #76	3.50	Brick Pavement							J.W. Johnson		1-20-14	
			2-C	Exten. P.H. 2-B-Bothell-Hollywood	4.92	Brick & Conc. Pavement							Cascade Constr. Co.		1-20-17	
			2-D	" P.H. 2-C	1.05	Brick Pavement							"		2-1-17	
			2-E	Bothell-Kirkland	2.87	Gravel									1917	
			2-F	"	2.49	"									1918	
			2-G	Kirkland-Houghton Road	1.35	"									1918	
			2-H	Houghton-Medina Road	5.02	Concrete									1918	
			2-J	Juanita Northerly	3.53	"									1918	
			2-K	" -Kirkland	3.60	"									1919	
			2-M	Hollywood-Redmond	4.47	"									1921	
			3	On State Aid Road No. 61	3.52	Bituminous Macadam							Bell Scott Co.		1912	
			3-A	" " " " " 69	2.84	Brick							T. Ryan		1913	
			3-B	Extension P.H. 3-A	3.00	"							D.A. Williams Co.		1914	
			3-C	Exten. P.H. 3-B to Co. Line & Auburn Conn.	3.60	"							John Contracting Co.		1915	
			3-D	Duwamish Bridge South	3.76	Concrete							Independent Asph. Pav. Co.		1918	
			3-E	Orillia-Kent Road	4.39	"							Albertson, Cornell, Bros. & Walsh		1922	
			4	North Trunk Boulevard	6.13	Brick									1922	
			5-A	Bellvue-Newport Rd.	3.27	Grading & Gravel									1914	
			5-B	" " " "	3.22	Concrete									1920	
			5-C	Redmond-Bellvue Rd.	1.90	Grading & Surfacing							G.H. Galloway Co.		1927	
			6	Geo. W. Peck Road	4.50	Gravel									1922	
			6-A	Kent Westerly	1.35	" & Concrete									1915	
			6-C	Des Moines Southwesterly	1.00	Concrete									1917	
			6-D	" - Kent Road	2.12	Gravel									1924	
			6-E	Kent-Des Moines Shore Line Rd.	1.65	" & Concrete Pavt.									1927	
			7	Newport-Issaquah	4.10	"									1926	
			7-B	Issaquah-Fall City	7.90	Crushed Rock									1915	
			11	Enumclaw-Buckley	3.25	Concrete Pavement									1915	
			11-A	" Westerly	2.54	"							J.M. Clapp		1916	
			11-B	Auburn-Enumclaw Road	5.11	"							Kaiser Paving Co.		1916	
			11-C	East End P.H. 11-B to P.H. 11-A	6.22	"									6-15-19	
			11-D	Between P.H. 11-B & 11-C	2.00	"							T.M. Morgan		10-1-19	
			11-E	Auburn-Black Diamond	2.50	"									1920	
			11-F	Enumclaw-Franklin	1.60	"									1920	
			11-G	" - Buckley	0.38	"									1927	
			12	Newport-Renton	1.83	Gravel & Grading									1916	
			12-A	Renton North	3.84	"									1918	
			12-B	" Newport	6.35	Concrete Pavement									1922	
			13	Enumclaw-LaFromboise Rd.	1.67	Grading & Surfacing									1916	
			14	Seattle Southerly	9.63	Monolithic Brick							Graff & Sheldon		1917	
			14-A	Des Moines Fill Gap	0.04	Concrete Pavement									1927	
			15	Duvall South	1.27	"									1917	
			15-A	Stillwater-Snohomish Co. Line	2.72	Grading & Gravel									1927	
			15-B	" " " "	1.34	"									1928	
			18	White River Bridge North	2.31	Concrete Pavement									1918	
			18-A	3 1/2 Kent-Auburn	4.50	"									1919	
			19	Tolt Southerly	1.00	"									1919	
			23	Renton Northwesterly	1.30	"									1919	
			25	Kent-Black Diamond	1.44	Gravel									1920	
			25-A	"	1.45	Concrete Pavement									1921	
			26	Pacific Hwy.-Renton Jct.	1.34	"									1921	
			27	Auburn-Pierce Co. Line	2.00	"									1921	
			28	" " " "	1.40	Grading & Gravel Surfacing									1921	
			28-A	" " " "	1.40	Conc. Pavt. & 270 Span Steel Br.									2-6-22	
			29	Renton-Maple Valley	3.98	Concrete Pavement									8-18-24	
			29-A	" " " "	0.14	Paving Gaps									1915	
			36	" SOUTHERLY	2.44	CONCRETE PAVEMENT									1927	
			36-A	J.E. BENSON COUNTY RD.	2.60	"									1925	
			37	" - Maple Valley	2.11	"									1925	
			43	Kent-Black Diamond	2.53	Concrete & Gravel									1925	
			43-A	" " " " So Road	1.12	" Pavement									1927	
			44	Redmond-Kirkland Shore Line Rd.	4.18	"									1929	
			44-A	Kirkland-Redmond Paving Gaps	0.50	"									1927	
			45	Stillwater-Snohomish Co. Line	1.686	Grading & Gravel									1930	
			46	" " " "	1.02	"									1929	
			47	Des Moines Vicinity	2.95	Concrete Pavement									1929	
			47-A	" MAPLE VALLEY ROAD	2.00	"									1928	
			49	" RENTON-MAPLE VALLEY RD.	2.21	"									1928	
			50	Lake Sammamish Shore Line Rd.	2.91	Gravel									1930	
			52	Des Moines-Zenith Road	1.00	Concrete Pavement									1929	
			53	Fall City-Tolt Revision #2 Rd.	5.22	Gravel									1930	
			54	Tash Road Section	2.98	Concrete Pavement									1929	
			55	Marine View Drive	1.23	Gravel									1929	
			55	" " " "	0.10	Steel Towers & Girder Bridge									1930	
			56	10th & N.E. M. Ray Sayles Road	2.34	Concrete Pavement									1930	
			57	Enumclaw-Black Diamond Rd.	1.14	"									1930	
			58	Auburn - " " "	1.06	"									1930	
			60	Sand Point Way	1.79	"									1930	
			61	Black Diamond North	1.39	"									1930	
			63	Sunnydale Vicinity	1.92	Crushed Gravel									1930	
			64	Dumas Bay Road	1.16	"									1930	
			64	" " " "	0.07	Steel Bridge									1931	
			66	Maple Valley Revision	0.84	Gravel									1931	
			71	Issaquah-Newport Road	2.74	Concrete Pavement									1931	
			74	Renton-Three Tree Point 1931 Ext.	0.75	Crushed Stone									1932	
			81	Juanita Bay Bridge	0.33	Pile Bent Bridge									1931	
			82	Neiser Slough Bridge	0.44	" Trestle "									1932	
			83	Lake Washington Blvd. Fill	0.04	Crushed Gravel									1932	
			85	Lake Sammamish Road Paving	1.97	Concrete Paving									1932	
			86	Sand Point Way	1.99	"									1932	
			87	Renton-Three Tree Point	1.66	"									1932	
			33	STATE AID ROAD NO. 4	2.88	Macadam			36057.45				Tacoma Bridge Co.		12-07	
			46	RENTON JCT. NEWPORT	3.64	Grading			23273.11				L.H. Soer		9-00	
			57	KIRKLAND-SAMMAMISH RIVER	5.00	Clearing & Grubbing			4289.25				de la Cruz Brothers		10-00	
			60	Scatter Creek-West	5.00	"										